

Unication

Unication Quick Guide

One-Way Signal Booster

1. BOOSTER OVERVIEW

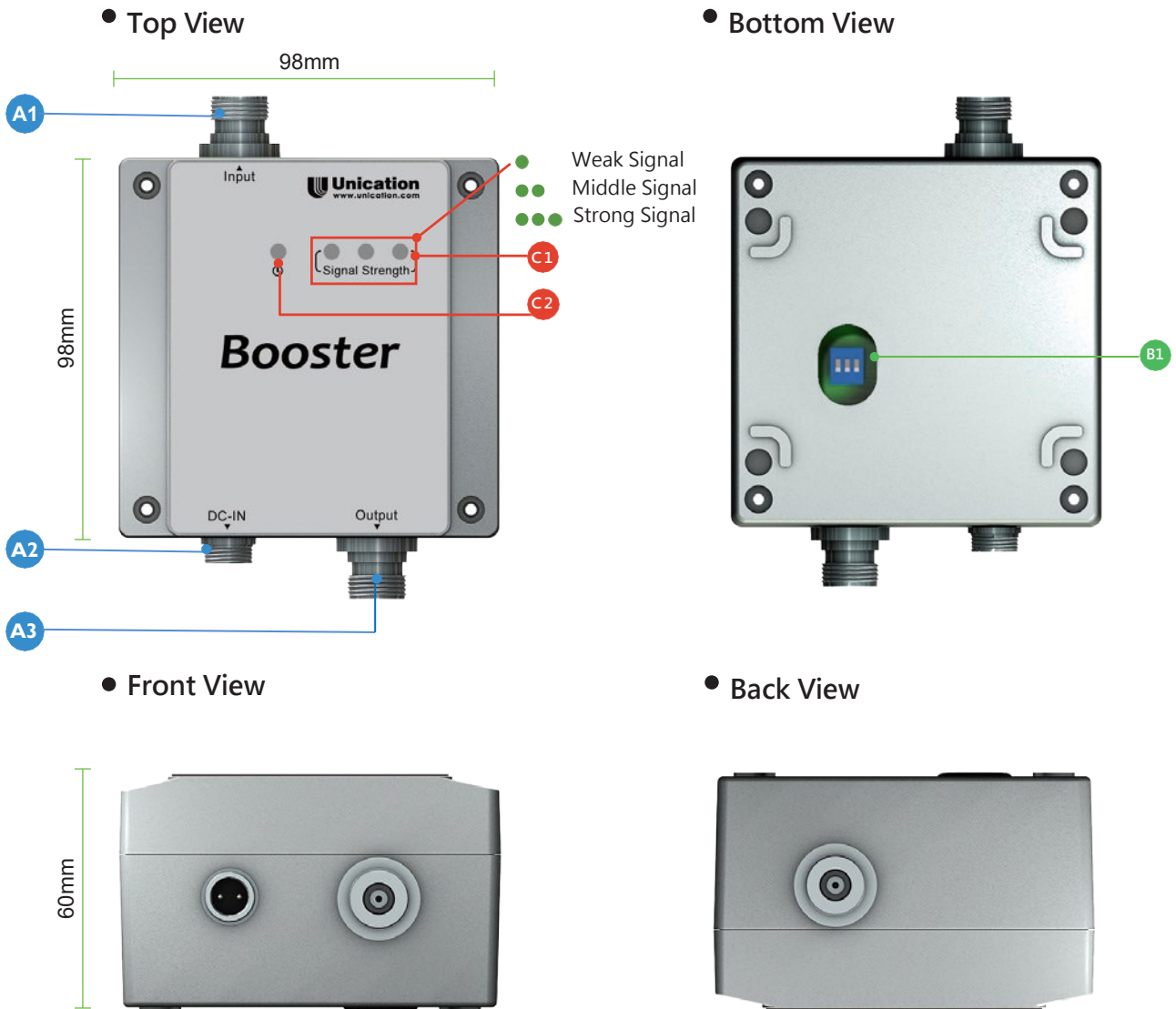

A: Interface

A1	Input (to Outdoor Antenna)	A2	Power Input	A3	Output (to Indoor Antenna)
----	-------------------------------	----	-------------	----	-------------------------------

B: Gain Switching

B1	Gain switch
----	-------------

2. BOOSTER SYSTEM DIAGRAM

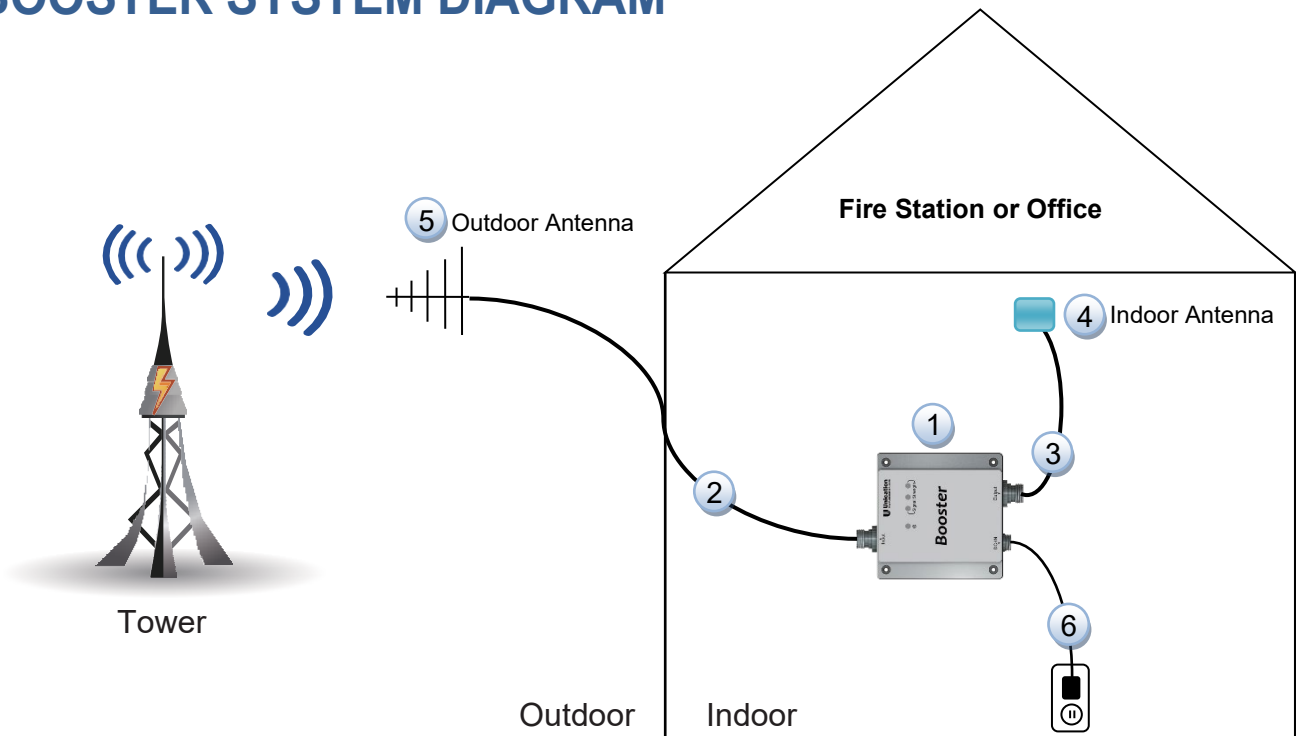

- 1 Booster
- 2 RF Cable (Booster to outdoor antenna)
- 3 RF Cable (Booster to indoor antenna)
- 4 Indoor Antenna
- 5 Outdoor Antenna
*Facing signal source direction
- 6 Power Cord

3. BOOSTER HIGH / LOW GAIN SWITCH DIAGRAM

Initial Setup- Booster High / Low Gain Settings:

	VHF / UHF	700 MHz	800 MHz	700/800 MHz
Low Gain Mode				
High Gain Mode				

- After installation, you may have to adjust gain settings depending on signal conditions.
- The above diagram outlines current switch positions for Low & High gain.
- To expand the indoor signal coverage, position the switch to the High gain setting.

Important Note: If the receiving range decreases when Booster is set to High gain there is signal interference in the area. To correct, change setting to Low Gain.

4. BOOSTER ACCESSORIES

Log-periodic Antenna (outdoor)



Omni Antenna (indoor)



Yagi Antenna (outdoor)



Antenna Bracket



RF Cable



Power Divider



Important Notes:

- Included in package: One-Way Signal Booster, AC Power Adapter, Power Cable, Wall Mount & Screws.
- Required Accessories: The One-Way Signal Booster requires the following accessories for operation:
 - *Two (2) RF cables*
 - *One (1) external antenna & mounting hardware*
 - *One (1) internal omni-directional antenna*
- Unication also recommends adding a lightning protector connection between the outdoor antenna and Booster to protect the Booster system from damage in case of lightning strike. We are planning an “accessory bundle package” that will be released at a later date.

Questions regarding the One-Way Signal Booster? Contact Unication via email at info@unication.com



www.unication.com